

Studio 1 & 2 Technical Specification

Stage Lighting System- Studios 1 & 2

Stage lighting Equipment

Item	Description	Typical manufacturer & model	QTY
LED stage lighting washlight.	LED source, black, with 3 diffusers per fixture. All accessories and power cable in black, with 15A plug tops.	ETC ColourSource PAR	6 3 per studio
Lighting Control Console- Small	With Flight Case	ETC ColourSource 20	1 shared resource
Internally Wired Bars	Custom, permanently installed stage lighting bars, 7050mm and 8800mm long, 48.3mm, OD, installed to rafters and walls		8 4 per studio

Audiovisual system- Studios 1 & 2

Item	Description	Componet type	Typical manufacture & model	QTY
2.63-MIX-06/ART	Analogue audio mixer	Rack mount digital mixer, 3 mono and 3 stereo inputs	ART MX622	2 1 per studio
2.63-LMP-07/PA2	Loudspeaker management processor	Loudspeaker management processor with input and output processors including graphic equalisers and time alligment	Doc driverack PA2	2 1 per studio
2.66-SSP-01/300	Solid state player	Rack mounted solid state recorder including USB input	Denon DN-F300	2 1 per studio
2.66-BAR-01/200	Bluetooth audio receiver	Bluetooth audio receiver to jack plug/ XLR balanced output	Denon DN- 200BR	2 1 per studio

2.65-FRS-EM/061	Large portable Loudspeakers	Passive fill loudspeaker, 90 x 60 degree dispersion, 6.5" LF driver, 1" HF driver, c/w mounting frame, bond and cable	EM acoustics EMS 61	4 2 per studio
Dance Mirror	Full-length	Right hand wall		Dance Studio only
Ballet Bars	Duel height	Right hand wall Window wall		Dance Studio only
Black Drape	Full-length	Right hand wall		Drama Studio only
Harlequin Dance Floor	full floor	NB appropriate footwear to be worn		Drama Studio
Harlequin Dance Floor	Full Floor	NB appropriate footwear to be worn		Dance Studio
Sprung Floor				Dance Studio
Black Out Shutters To all windows				Dance/Drama Studios.

Technical Specification for Malt House Theatre

Lighting Fixtures

Fixture	Description	Manufacturer	Quantity
Parcan 64	Gobo holders and bar doors	N/A	17
Source 4 750's	19 degree profile	ETC	6
Source 4 750's	15- 30 degree lenses	ETC	12
Source 4 750's	26 degree lenses	ETC	6
Parcan 56 short	Short conventional Parcan	N/A	2
Colour source Lustra's	LED profile with 36 degree lens	ETC	12
Source 4 zoom	25-50 degree	ETC	12
Source 4 Fresnel	Conventional Fresnel with barn doors and Gel holders	ETC	22
Cantata F Fresnel	Conventional Fresnel with barn door, and gel holder	Strand	4
Cantata Pc Fresnel	Conventional Fresnel with barn doors, and gel holder	Strand	4
Source 4 Juniors Zoom	25- 50 degree zoom able profile, with gobo holder, shutters and gel holder	ETC	5
Acclaim Fresnel	Conventional Fresnel with barn door, and gel holder	Strand	6
Source 4 Zoom	25-50 degree lens, with gob holder, and shutters	ETC	2
Quartet F	Conventional Fresnel with barn doors, and gel holder	Strand	2
Quartet Pc	Conventional Fresnel with barn doors, and gel holder	Strand	2

743 Fresnel	Conventional Fresnel with barn doors, and gel holder	Strand	4
Fest dooms	12 bulb strip lighting	N/A	5 sets

Lighting Cables

<u>Cable Type</u>	<u>Length</u>	<u>Quantity</u>
15-amp extension cable	5 metre	40
15-amp extension cable	10 metre	10
15-amp extension cable	15 metre	6
6-way multicore breakout cable, 15A socket connectors	1 metre	18
DMX	1 metre	6
DMX	5 metre	6
DMX	10 metre	6
DMX	15 metre	6
DMX	20 metre	6
Power con	1 metre	12
13 amp -15amp extension	N/A	1
Ethernet – DMX adapters	1 metre	12
Grelcos	N/A	6

Lighting Bars

14 motorised bars, 6 upstage and 8 down stage. Controlled from either stage left or stage right using control tablet.

3 lighting bridges, with 1 lighting bar either side of the bridge.

Lighting accessories

- Barn doors attached to all fixtures, with barn doors available for par cans.
- Various sized Gel frames
- Various sized Gobo holders

Control Desk

ETC Ion lighting control, with detachable fader wing, currently operating 2 universes.

Dimmers

- Colour source dimmer rack
- 250 dimmable channels
- 2 universes

Hazers

- Le Matire MVs hazer x1, can be controlled from lighting console
- Sky Walker fog generator, can be controlled from lighting console

Projection/AV

- Drop down screen centre stage
- Christie d13hd-hs

Sound

Sound control

- Yamaha TF1/ QL1 sound desk 16 channel
- 2 mac minis to run Qlab and other software required
- Yamaha MTX5-D, rack mounted DSP 16 channel I/O Dante, 8 channel I/O analogue.
X1

Microphones

<u>Microphone</u>	<u>Type</u>	<u>Quantity</u>
Shure SM58	Dynamic Vocal instrument	4
Shure SM57	Dynamic instrument microphone	4
Sennheiser/Shure	Radio microphone	
Microphone Stand	Adjustable height fitted with boom arm	4
Microphone Stand	Adjustable height, low level, fitted with boom arm	4
DI box	Phantom powered Direct injection box in rugged ABS casing	6

Sound cables

- XLR cables in various lengths
- Jack to jack in various lengths
- Audio patch cable with BPO connectors x10
- XLR- Jack x 4
- XLR-Jack solid adapter x1

Speakers

<u>Speaker</u>	<u>Size</u>	<u>Quantity</u>
EM acoustics EMS 51	Small portable loudspeaker	6
EM acoustics EMS 61	Large portable loudspeaker	4
EM acoustics EMS 81x	Large portable loudspeaker	6
Subwoofer	Large subwoofer	2

Amps

Lab gruppen, 2 channel amplifier. 2 channel amplifier capable of delivery 800w per channel into 8 ohms

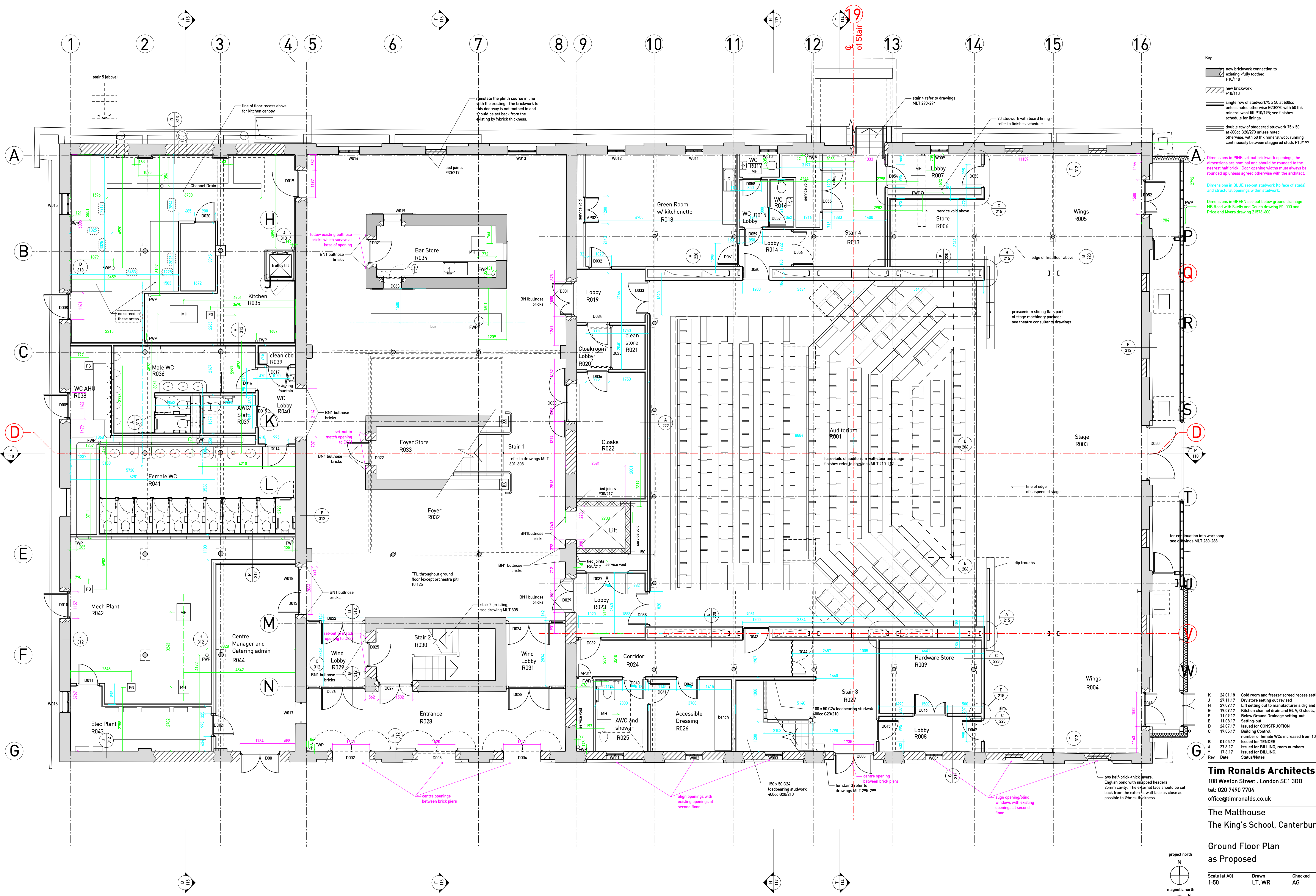

Key

- new brickwork connection to existing - fully toothed F10/110
- new brickwork F10/110
- single row of studwork 75 x 50 at 600cc unless noted otherwise G20/270 with 50 tsk mineral wool fill P10/195; see finishes schedule for linings
- double row of staggered studwork 75 x 50 at 600cc G20/270 unless noted otherwise, with 50 tsk mineral wool running continuously between staggered studs P10/197

Dimensions in PINK set-out brickwork openings, the dimensions are nominal and should be rounded to the nearest half brick. Door opening widths must always be rounded up unless agreed otherwise with the architect.

Dimensions in BLUE set-out studwork (to face of studs) and structural openings within studwork.

Dimensions in GREEN set-out below ground drainage NB Read with Skelly and Couch drawing R1-000 and Price and Myers drawing 21576-000

K	24.01.18	Cold room and freezer screen recess setting out
J	27.11.17	Dry store setting out revised
H	27.09.17	Lift setting out to manufacturer's drg and FFL
G	19.09.17	Kitchen channel drain and GL V, U steels, ducts
F	11.09.17	Below Ground Drainage setting-out
E	11.08.17	Setting-out
D	24.07.17	Issued for CONSTRUCTION
C	17.05.17	Building Control number of female WCs increased from 10 to 11
B	01.05.17	Issued for TENDER
A	27.3.17	Issued for BILLING, room numbers
	17.3.17	Issued for BILLING
Rev	Date	Status/Notes

Tim Ronalds Architects
 108 Weston Street - London SE1 3QB
 tel: 020 7490 7704
 office@timronalds.co.uk

The Malthouse
 The King's School, Canterbury

Ground Floor Plan
 as Proposed

Scale (at A0) 1:50
 Drawn LT, WR
 Checked AG

MLT 102 K

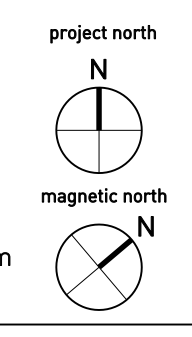

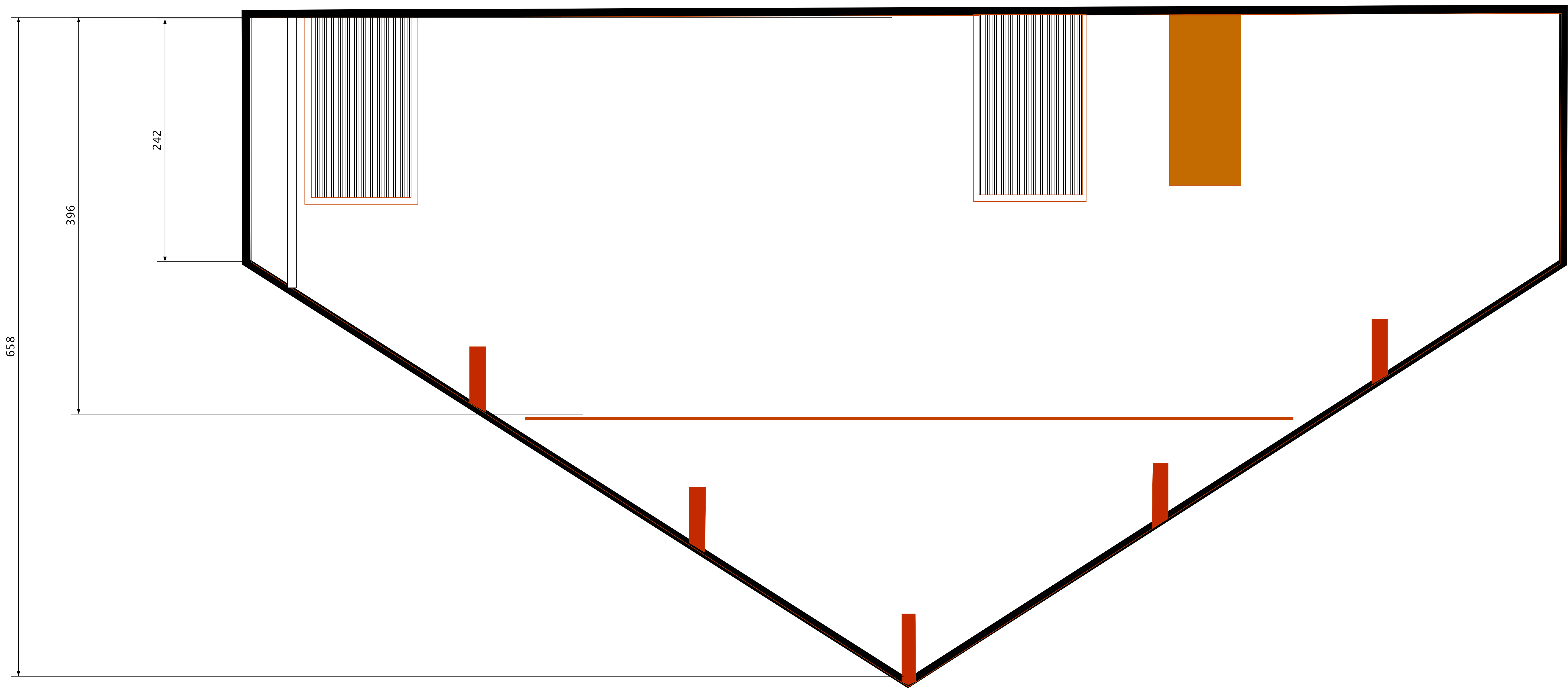
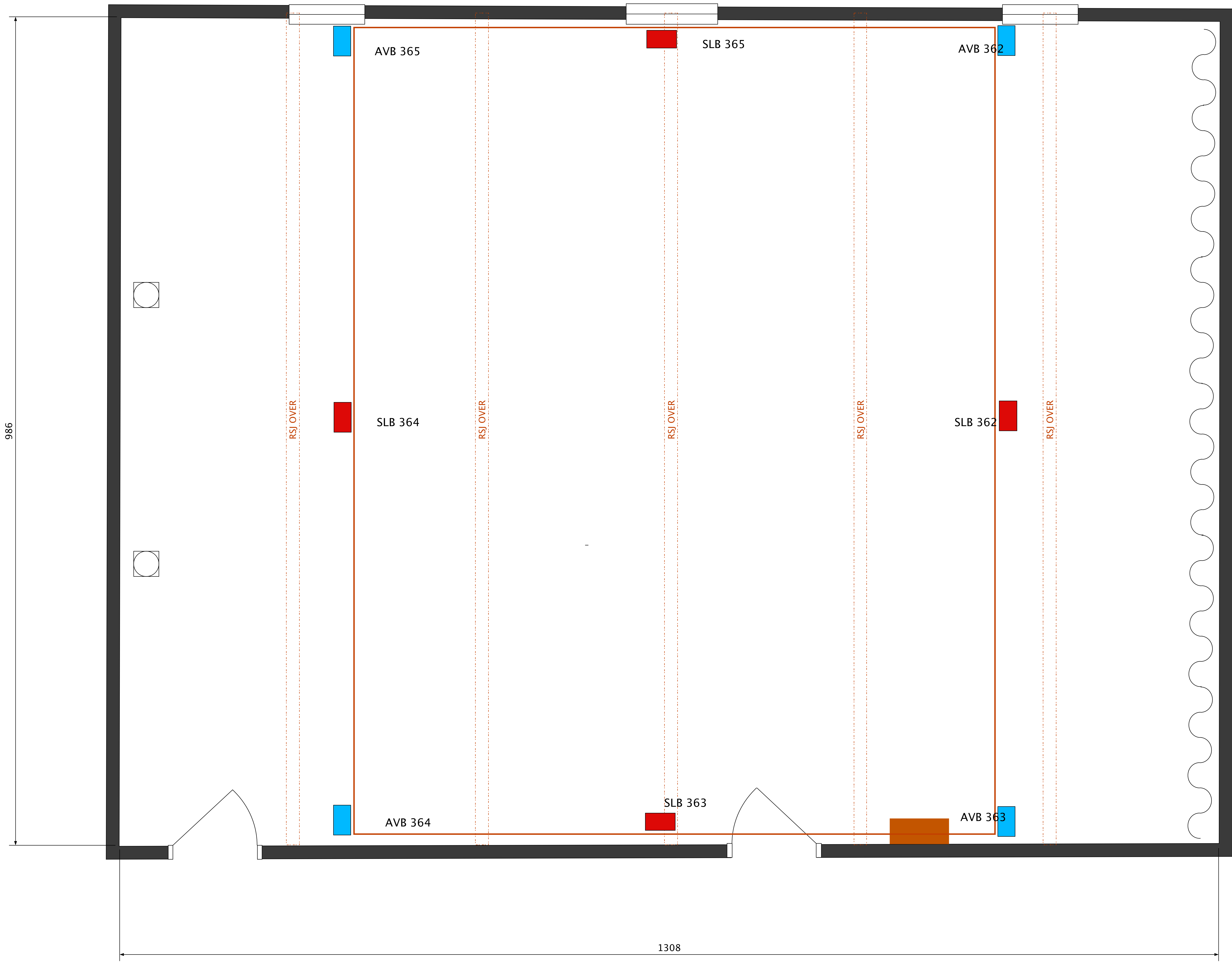

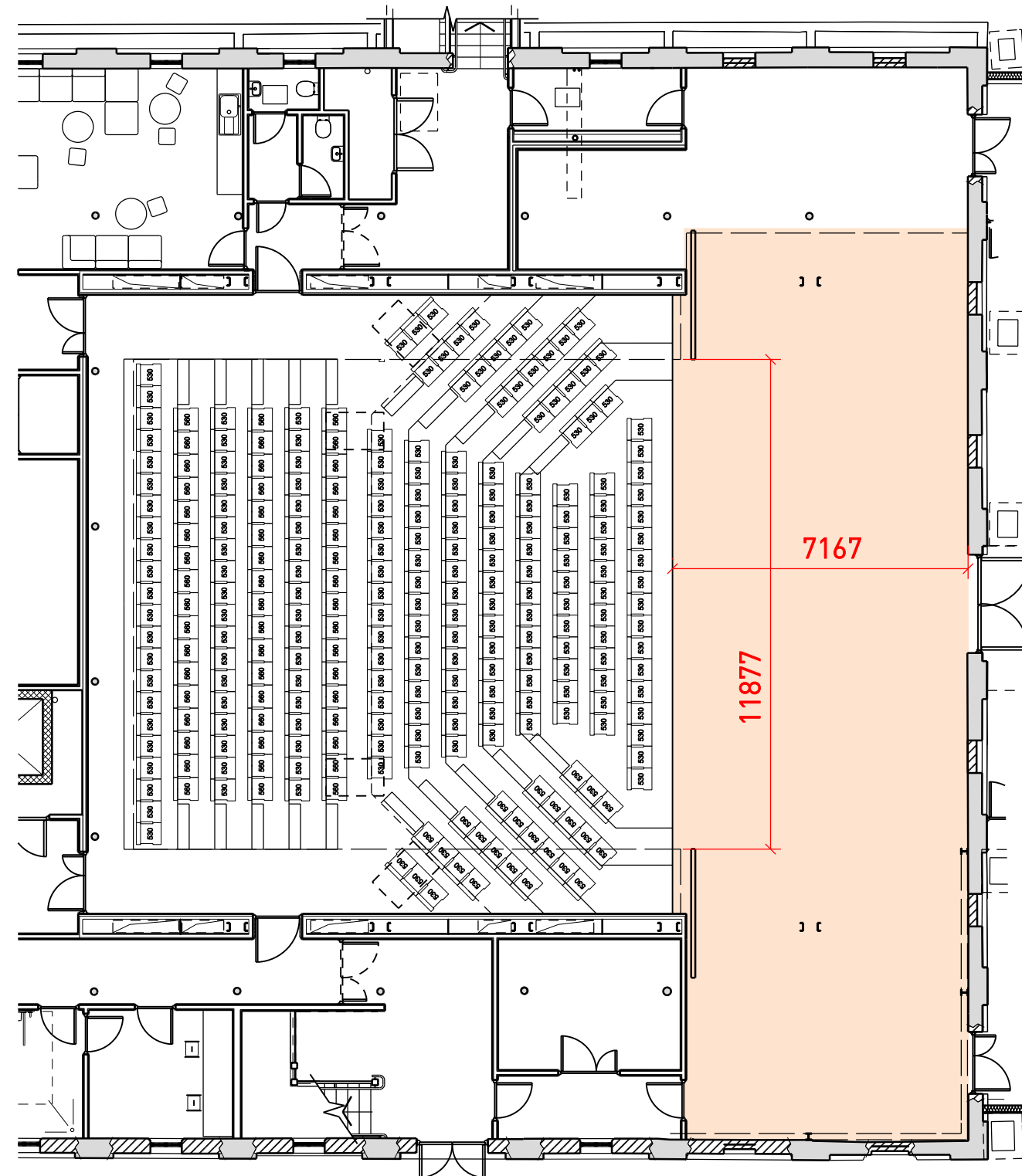

1. End Stage

Seated audience (stalls + gallery): 334
 Standing (gallery only): 50
 Stage depth 7.15 m
 Proscenium width 10 m (variable)

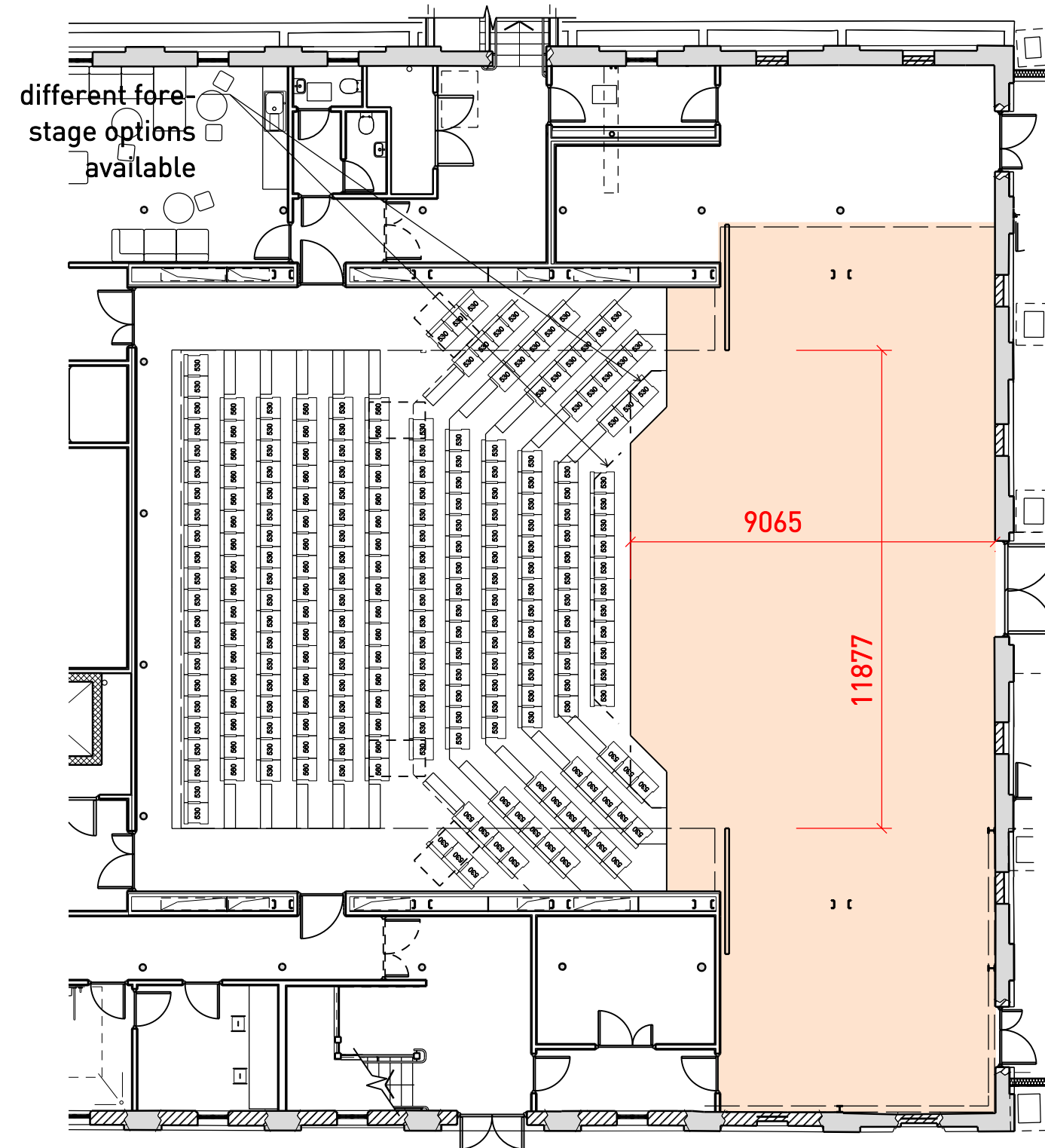

2. End Stage with Forestage

Seated audience (stalls + gallery): 305
 Standing (gallery only): 50
 Stage depth 9.05 m
 Proscenium width 10 m (variable)

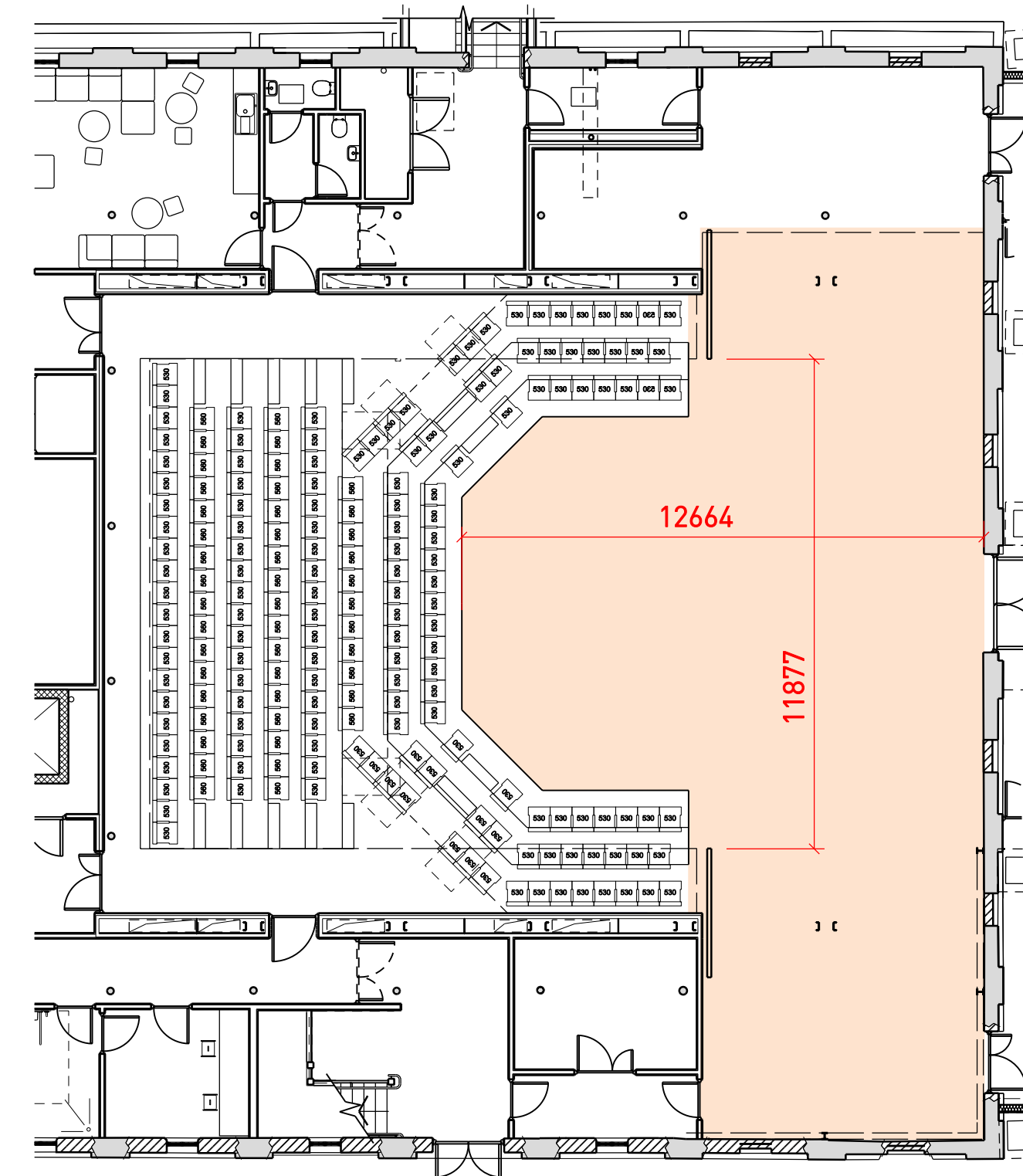

3. Thrust Stage

Seated audience (stalls + gallery): 261
 Standing (gallery only): 50
 Stage depth 12.65 m
 Stage width 9.05 m

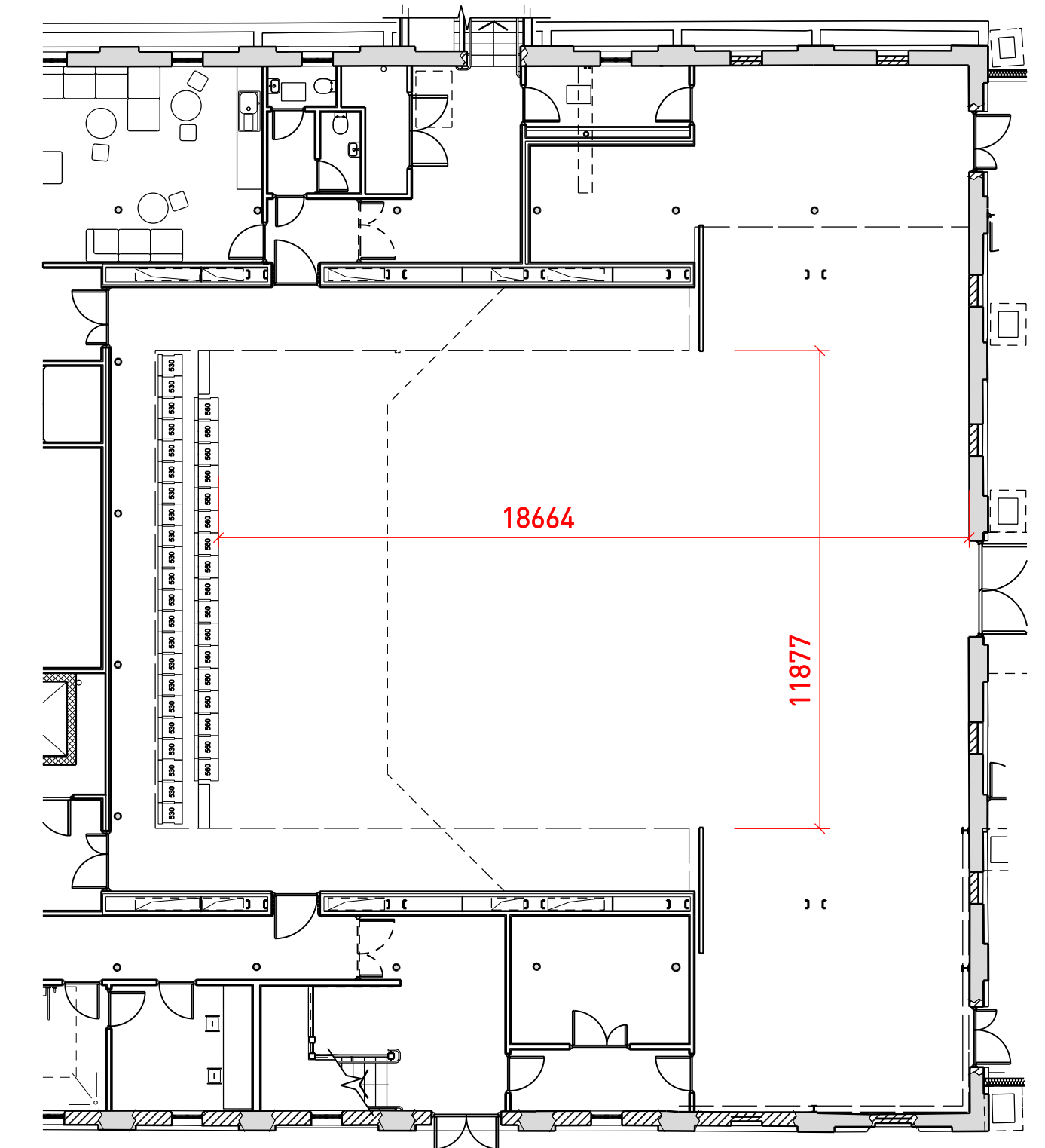

4. Studio

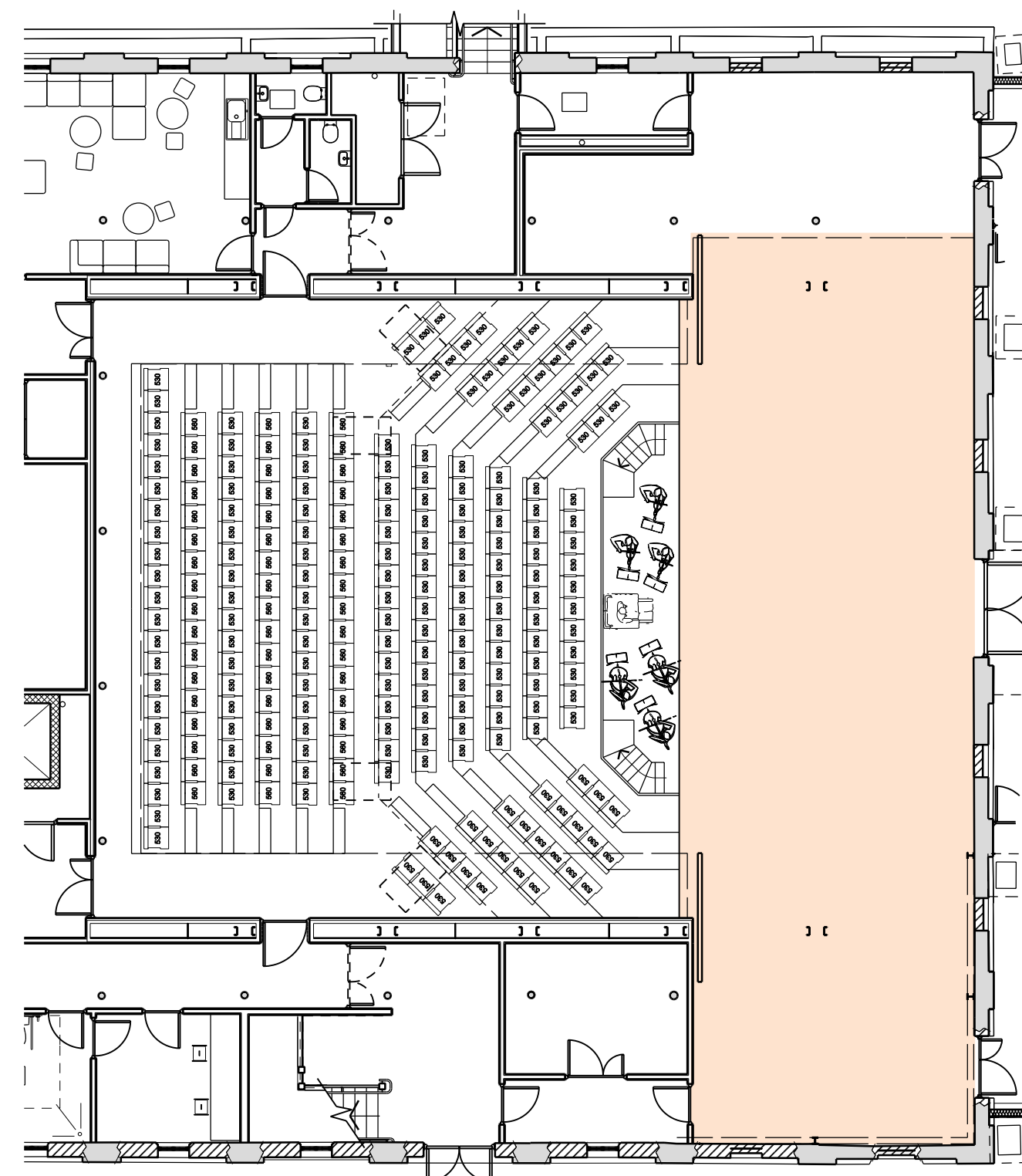

5. End Stage with Orchestra Pit

Seated audience (stalls + gallery): 305
 Standing (gallery only): 50
 Musicians: 12
 Stage depth 7.15 m
 Proscenium width 10 m (variable)

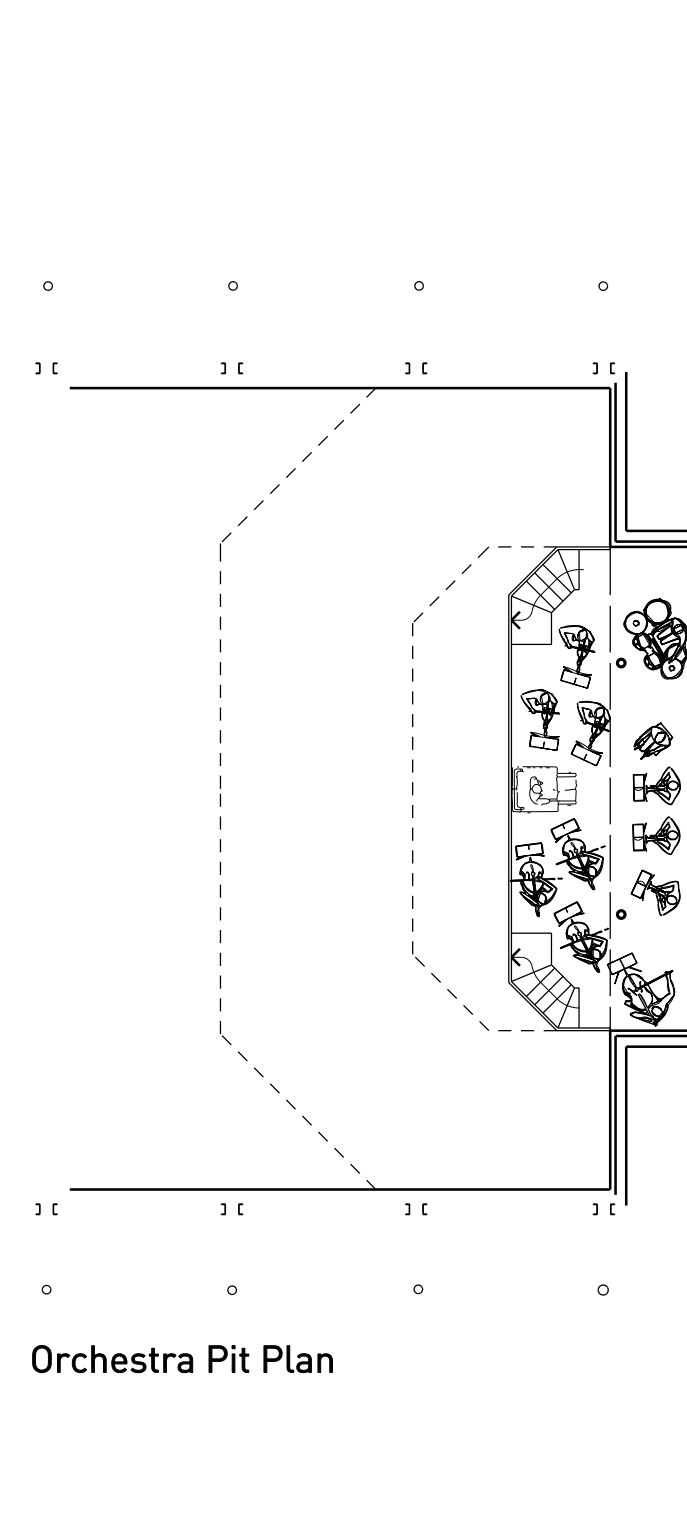

Orchestra Pit Plan

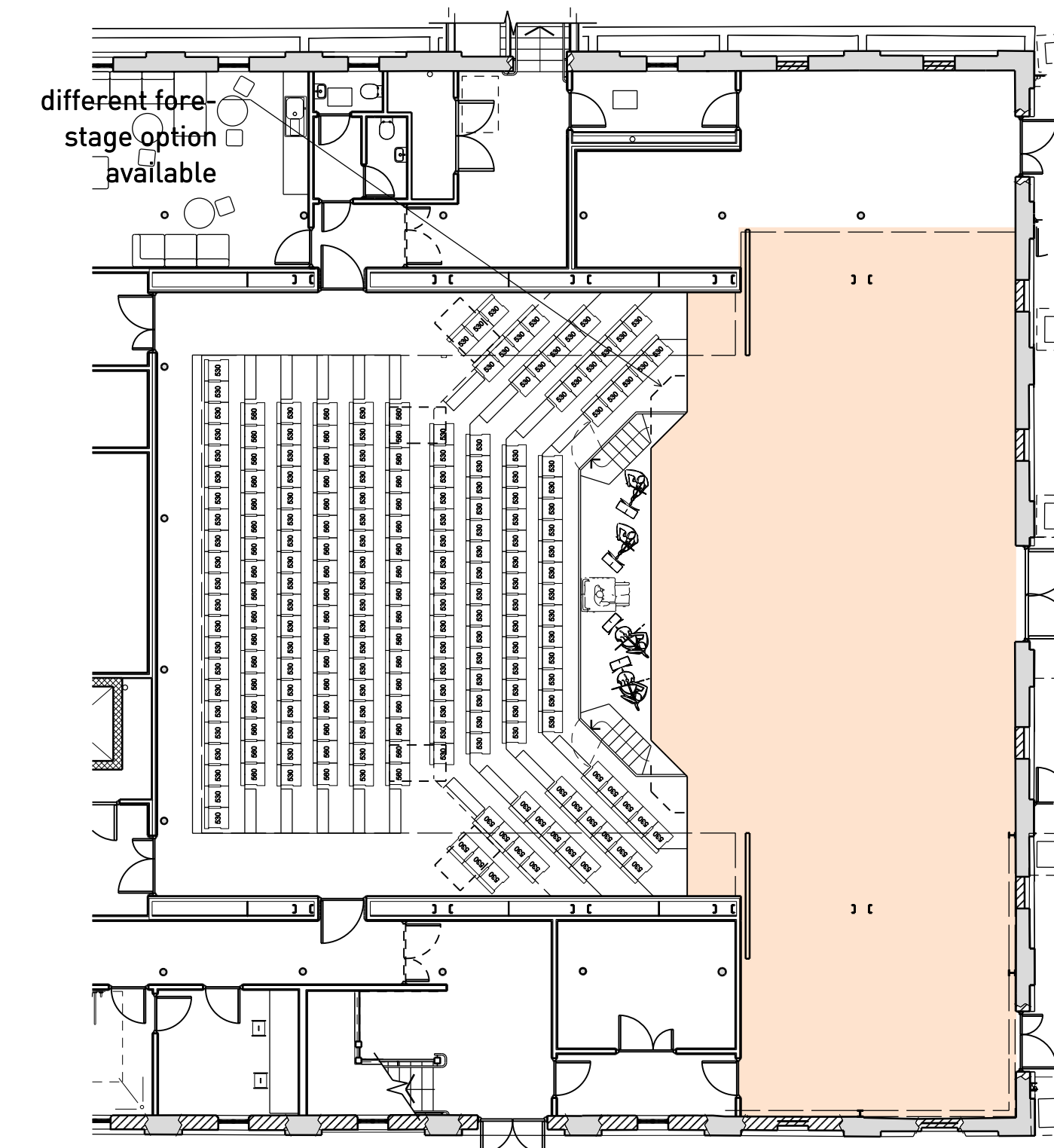

6. End Stage with Orchestra Pit and Forestage

Seated audience (stalls + gallery): 276
 Standing (gallery only): 50
 Musicians: 20
 Stage depth 9.05 m
 Proscenium width 10 m (variable)

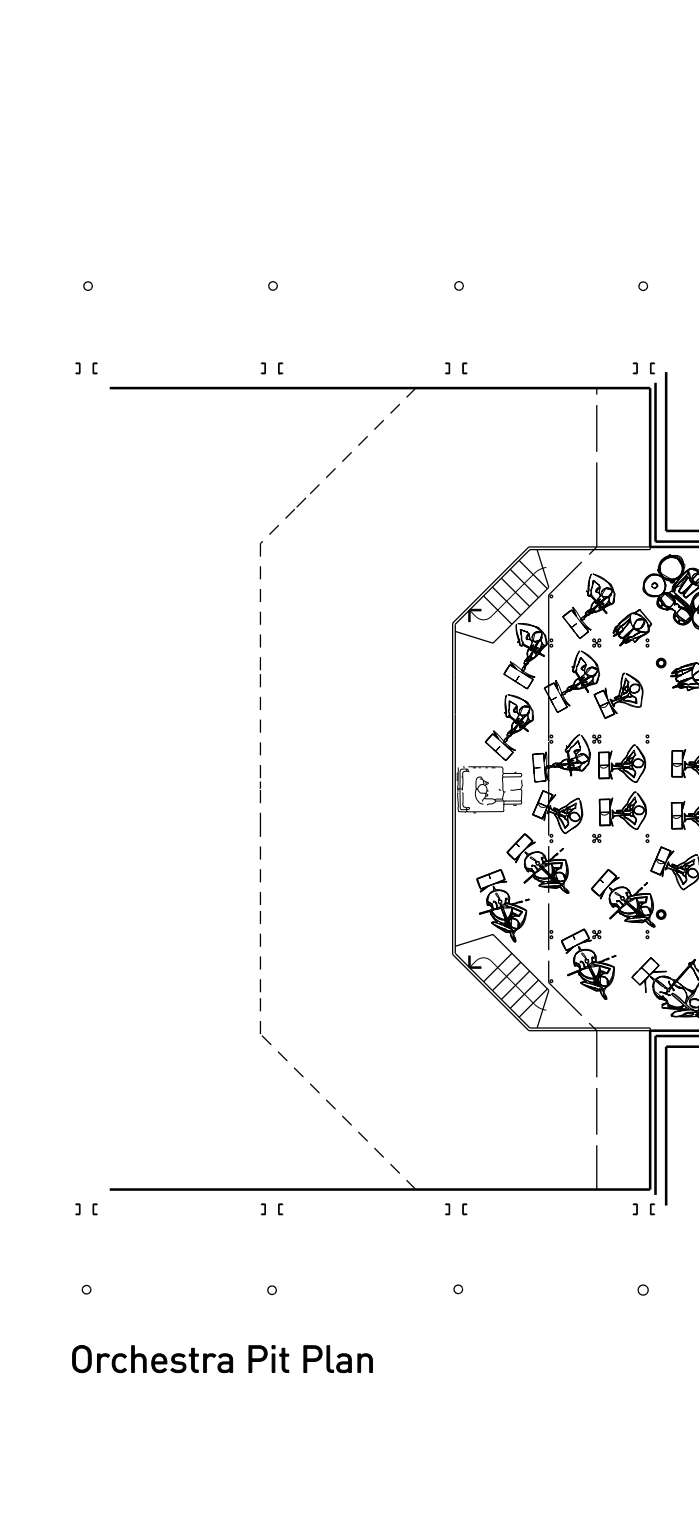

Orchestra Pit Plan

Rev	Date	Status/Notes
E	23.12.16	Revised to show all major theatre configurations.
D	22.12.15	Revised to show various pit layouts.
C	14.11.16	Revised Stage 4 backgrounds
B	08.11.16	Stage 4/E backgrounds
A	04.11.16	To KSC drama
*	03.11.16	To fire engineers

Tim Ronalds Architects
 108 Weston Street . London SE1 3QB
 tel: 020 7490 7704
 office@timronalds.co.uk

The Malthouse
 The King's School, Canterbury

Theatre Configurations

Scale (at A0)	Drawn	Checked
1:100	LT	AG



MLT 030 E